



St. Martins Walk, Ely, CB7 4QF

CHEFFINS

St. Martins Walk

Ely,
CB7 4QF

Two-bedroom terraced house located in the City centre. Accommodation comprises of entrance hall, newly fitted kitchen, dining/living room, two bedrooms, bathroom, enclosed low maintenance courtyard garden and allocated parking. Available: 11/05/2026. Deposit: £1,269. Holding fee: £253. Council tax band: B. EPC: C

LOCATION

Ely is an historic Cathedral City which provides an excellent range of shopping facilities, schools catering for all ages and various sporting and social activities including the recently opened Ely Leisure Village incorporating multi-screen cinema and restaurants. The main A10 road at Ely provides access to Cambridge which in turn links with the A14 and M11 motorway to London. Ely also has a mainline station which provides an electrified rail service to Cambridge and London.

2 1 1

£1,100 PCM





ENTRANCE HALL

with under stair storage cupboard.

KITCHEN

with vinyl flooring, newly fitted units, integrated oven, ceramic hob, extractor and plumbing for washing machine.

DINING/LIVING ROOM

with French doors to the rear garden.



BEDROOM

BEDROOM

SHOWER ROOM

with vinyl flooring and walk in electric shower.

OUTSIDE

rear courtyard garden and allocated parking.



LETTING AGENTS NOTES

For more information on this property please refer to the Material Information brochure on our Website.



Ground Floor
Approx. 30.3 sq. metres (326.0 sq. feet)

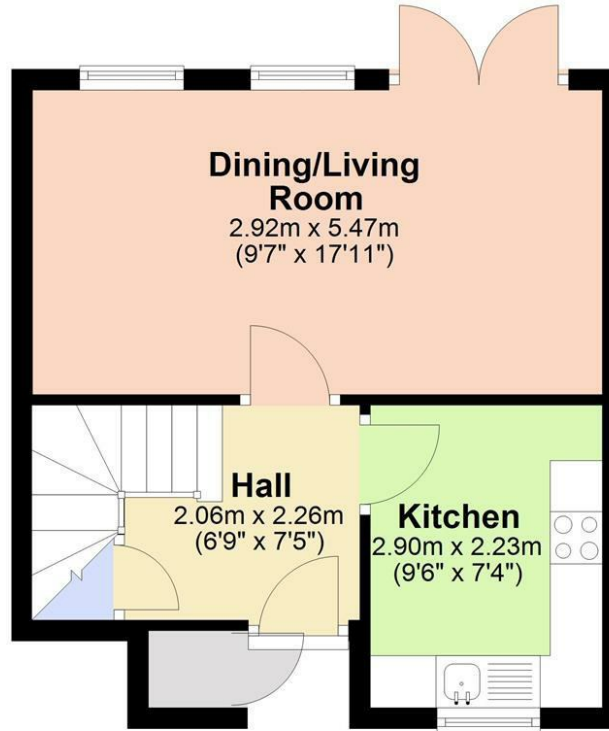

First Floor
Approx. 30.5 sq. metres (328.6 sq. feet)

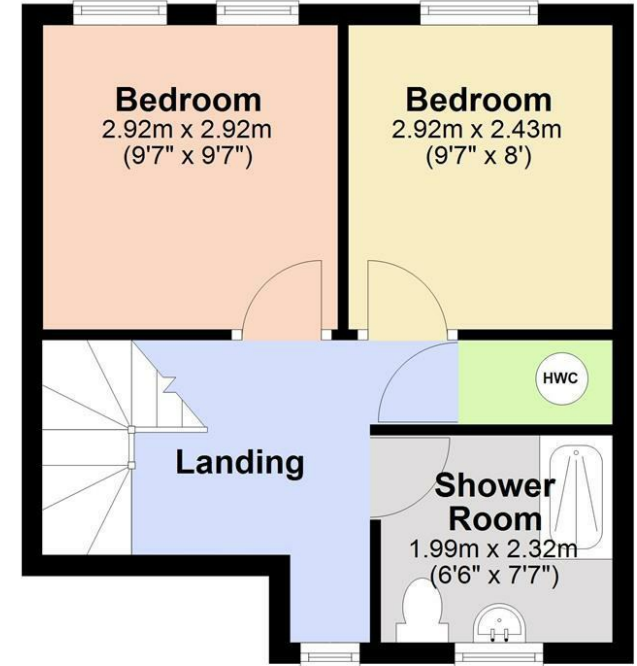

Total area: approx. 60.8 sq. metres (654.6 sq. feet)

Energy Efficiency Rating	
Current	Potential
Very energy efficient - lower running costs	
(92 plus) A	
(81-91) B	
(69-80) C	78
(55-68) D	70
(39-54) E	
(21-38) F	
(1-20) G	
Not energy efficient - higher running costs	
EU Directive 2002/91/EC	

Agents note:
For more information on this property please refer to the Material Information Brochure on our website.

25 Market Place, Ely, Cambridgeshire, CB7 4NP | 01353 663144 | cheffins.co.uk

IMPORTANT: we would like to inform prospective purchasers that these sales particulars have been prepared as a general guide only. A detailed survey has not been carried out, nor the services, appliances and fittings tested. Room sizes should not be relied upon for furnishing purposes and are approximate. If floor plans are included, they are for guidance only and illustration purposes only and may not be to scale. If there are any important matters likely to affect your decision to buy, please contact us before viewing the property.

